



IMS PRODUCTIONS

field production
studio production
post production
remote production
radio network
satellite services

IMS PRODUCTIONS • 4555 W 16th St • INDIANAPOLIS, IN 46222
OFFICE 317.492.8770 • FACSIMILE 317.492.8746 • WEB IMSPRODUCTIONS.TV

IMS HD-1 Spec Sheet

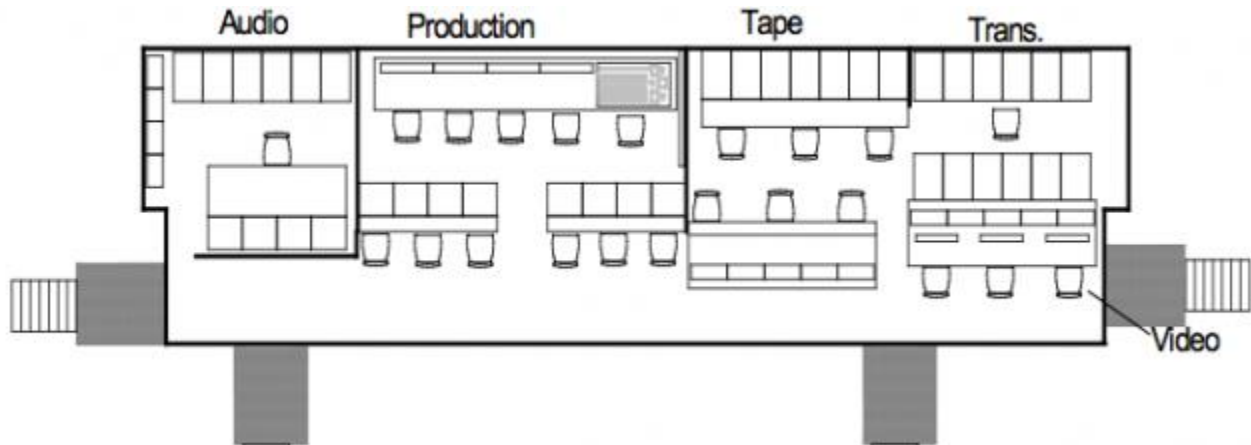

PRODUCTION

- 2 Bench expando
- 5 Position 1st bench
- 2-3 Position 2nd and 3rd benches

SWITCHING

- Kalypso
- 6 Trans-form Engines, Internal Still-Store with KlipCache, Kurl, Spektra Lighting, Glow, De-Focus FX
- Abekas Dveous MX HD
- Lance TDC 100 Controller
- Fingerworks Telestrator

CAMERAS

- 5 Sony HDC 1000 Studio Cameras
- 5 Sony HDC 1500 Hand Held Cameras
- 3 Sony HDLA 1500 Large Lens Adapters
- *All with SMPTE, ST SM Fiber or Triax Capability
- 4 Canon 100x Semi Servo Lens
- 4 Canon 86x Semi Servo Lens
- 1 Canon 75x Semi Servo Lens
- 5 Canon 22x Hand Held Lens

GRAPHICS

- Chyron Mosaic XL (Matrox) (wired for 2)

AUDIO

- Calrec 64 Channel Bluefin Sigma Console
- 128 AES In, 128 Analog In
- Genelec Monitors with Blue Sky Controller
- 2 Digicart E Recorders
- Denon CD player

- 8 Sennheiser HMD 26 announce headsets
- 8 Announce Boxes with Talk-Back
- 6 Sennheiser ME 66 Short Shotguns
- 6 Sennheiser ME 67 Long Shotguns
- 6 Sennheiser MKH 416 P48s
- 4 EV RE 50s
- 5 Shure SM 58s
- 6 Sony ECM 66s
- 4 Sony ECM 77s
- 1 AT BP 4027 Long Stereo Shotgun
- 4 AT BP 4029 Stereo Shotguns
- 4 EV 635s
- 2 Shure Stereo VP 88s
- 6 Shure FP 23 Line Amps
- 3 Sound Devices MM-1 Line Amps



IMS PRODUCTIONS

field production
studio production
post production
remote production
radio network
satellite services

IMS PRODUCTIONS • 4555 W 16th St • INDIANAPOLIS, IN 46222
OFFICE 317.492.8770 • FACSIMILE 317.492.8746 • WEB IMSPRODUCTIONS.TV

RECORDING

Panasonic AJ-HD1800P DVCPPro
Sony HDW-1800 HDCam
Sony PDW-HD1550 XD Cam
3 6-ch EVS XT-3 LSM
2 6-ch EVS XT-3 RO
1 4-ch EVS XT-3 Spotbox
1 EVS XFile3
EVS XHub3
2 DVD Recorders

ROUTING

NVision 288 x 312 HD
NVision 448 X 640 Mono AES
NVision 192 X 192 Mono Analog

COMMUNICATIONS

RTS ADAM 190 Ports with RVON
KP 32 Panels
12 PL Channels
16 IFB Channels
10 RTS 4030 IFBs
24 RTS 325 Belt Packs
3 Biscuit Stations
8 TIF-4000 Telephone Interfaces
2 Motorola XPR 4550 Radio Base Stations
12 Motorola XPR 6550 Portable Radios
Partner 18-Line Key System
8 QKTs
4 Ring-downs
2 Epson WF-3640 Print/Scan/Copy/Fax

VIDEO MONITORING

232 Input Evertz MVP System with SDI Output

Production

8 46" Clarity LCD

Rear Bench

2.4/5GHz Wi-Fi

8 Marshall Dual V-R1042 10" HD each

Recording/Replay

7 32" Sony LCD

Video

3 32" Sony LCD
3 Sony BVM L230

Audio

3 32" Sony LMD-9050
1 14" Sony BVM-A145U (QC)

Field

14 7" EyeMax

POWER

208 VAC 3-Phase 200 Amp
150' Camlock cable
2x 10-Ton HVAC

DIMENSIONS / WEIGHT

55' Trailer with AC
Deployed footprint
50' x 7' deployed footprint
(add 4' if Side Porches are used)
80,000 lbs.
Travels with 53' support unit

Available upon request:

Fiber Booth Kit
4 Bank Telecast Adders
4 IFBs
4 2-channel PLs
SAP 612
24-Channel Line Out
40-Channel Line In
Wide Angle lens