

## IMS HD-2 Spec Sheet

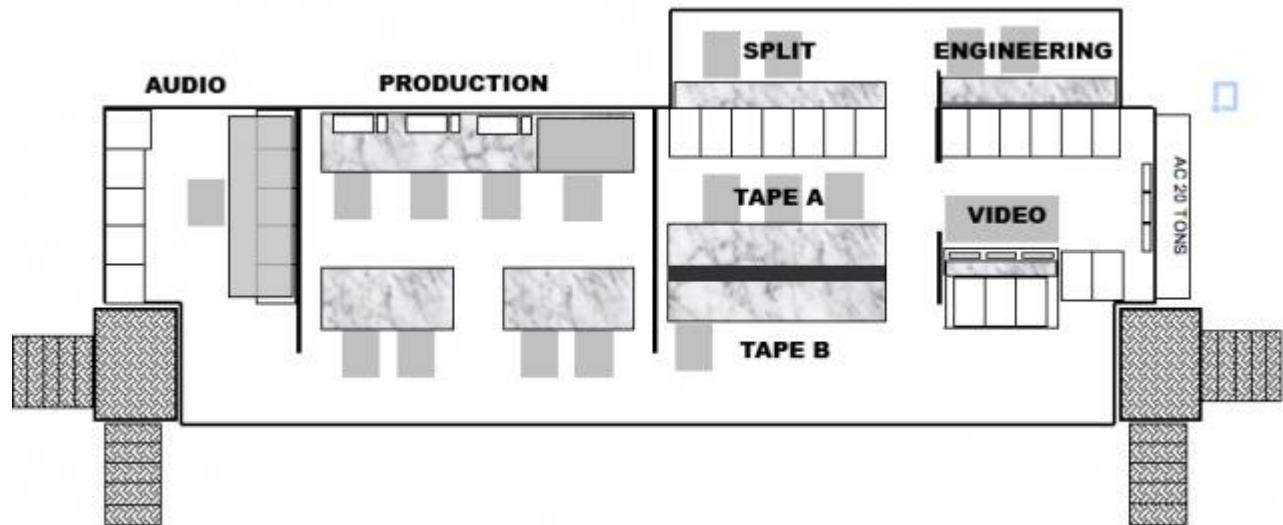

### PRODUCTION

- 2 Bench expando
- 4-5 Position 1<sup>st</sup> bench
- 4 Position rear bench

### SWITCHING

- GVG Kayenne 4.5 ME 96 Input with Mini ME
- 20 transform engines, internal still store with Klip Cache, Kurl, Spektra Lighting, Glow, Defocus Effects
- 2 Lance TDC 100 Controller
- Fingerworks Telestrator

### CAMERAS

- 4 Sony HDC 1000 Studio cameras
- 4 Sony HDC 1500 Hand Held
- All with Triax, SMPTE Fiber or Fiber Capability
- 4 Canon 100x Semi Servo Lens
- 4 Canon 22x Hand Held Lens
- 10 CCU's (wired for 16)

### GRAPHICS

- Chyron Mosaic XL (Matrox) (wired for 2)

### AUDIO

- Calrec 64 Channel Bluefin Sigma console
- 128 AES In, 128 Analog In
- Genelec Monitor s with Blue Sky Controller
- 2 Digicart E
- Denon CD player
- Dolby E Encoding
- SRS Circle Surround Encoding
- 6 Sennheiser HMD 25 announce headsets
- 8 announce boxes with talkback
- 5 Sennheiser ME 66 short shotguns
- 3 Shure SM 89 long shotguns
- 3 Shure SM 89 Short shotguns
- 5 Shure Beta 58
- 4 Sennheiser MD 46
- 4 Sennheiser 416
- 4 Sony ECM 77
- 4 Sony ECM 66
- 10 Shure FP 23 line amps
- 2 VP 88



IMS PRODUCTIONS • 4555 W 16th ST • INDIANAPOLIS, IN 46222  
OFFICE 317.492.8770 • FACSIMILE 317.492.8746 • WEB IMSPRODUCTIONS.TV

---

## RECORDING

2 AJ- HD-1800 DVC Pro  
2 Sony HDCAM  
2- 6 ch EVS XT-3 LSM  
2- 6 ch EVS XT-3 RO  
1- 4 ch EVS Spotbox  
X-File3 and Sports Hub  
2 DVD Recorders

## ROUTING

N Vision 288 x 504  
224 X 256 AES  
192 X 192 Analog

## COMMUNICATIONS

RTS ADAM 190 ports Tribus & Rvon  
KP 32 and KP 12 Panels  
12 PL channels  
16 IFB channels  
20 BP 325  
2 Biscuit Boxes  
8 Telephone interfaces  
2 Radio base stations  
12 Motorola GP 100  
Partner 18-line key system  
8 QKTs  
4 Ringdowns

## MVP MONITORING SYSTEM

### Production

8 46" Panasonic LCD  
8 10" Marshall

### Tape/ Dual

12 32" Sony LCD

### Video

2 32" Sony LCD

3 Sony BVM L230

### Rear Bench

8 Marshall Dual V-R1042 10" HD each

### Field

4 Sony 9" LCD  
4 JVC 17" LCD  
2 Sony 20" LCD

### POWER

208 volt 3 phase 200 amps  
150' Camlok cable  
20 ton HVAC

### DIMENSIONS / WEIGHT

55' trailer with AC  
**Deployed footprint**  
50'X5' curbside expando  
25'X4' roadside expando  
13'6" height clear  
8'6" wide clear (transport)  
80,000 pounds

### Available upon request:

2 Sony HDLA 1500 HD Build Up  
2 Canon 86x Semi Servo Lens  
Wide Angle lens  
Additional microphones  
Fiber Booth Kit  
Sap 612  
4 Model 47 PL's  
4 Model 46 PL's  
(2 wired to 612, but only pin 2 powered)  
4 Model 42A IFB's  
Adder 16 send 8 Receive

\*53' support unit required for larger shows.