

IMS HD-2 Spec Sheet

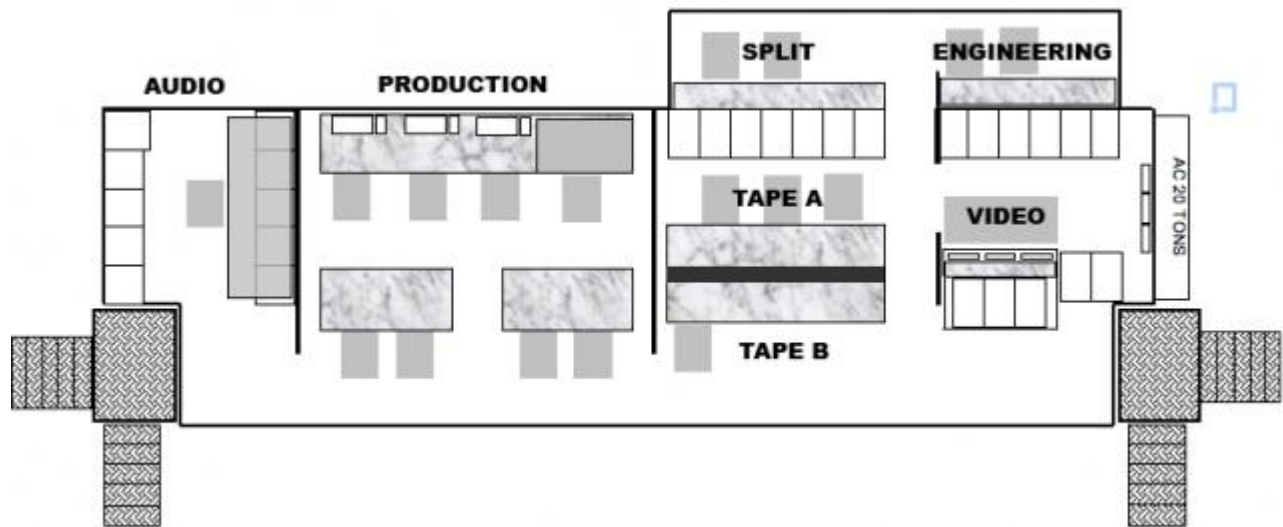

PRODUCTION

2 Bench expando
4-5 Position 1st bench
4 Position rear bench

SWITCHING

GVG Kayenne 4.5 ME 96 Input with Mini ME
20 transform engines, internal still store with
Klip Cache, Kurl, Spektra Lighting, Glow, Defocus
Effects
2 Lance TDC 100 Controller
Fingerworks Telestrator

CAMERAS

4 Sony HDC 1000 Studio cameras
4 Sony HDC 1500 Hand Held
All with Triax, SMPTE Fiber or Fiber Capability
4 Canon 100x Semi Servo Lens
4 Canon 22x Hand Held Lens
10 CCU's (wired for 16)

GRAPHICS

Chyron Mosaic XL (Matrox) (wired for 2)

AUDIO

Calrec 64 Channel Bluefin Sigma console
128 AES In, 128 Analog In
Genelec Monitor s with Blue Sky Controller
2 Digicart E
Denon CD player
Dolby E Encoding
SRS Circle Surround Encoding
6 Sennheiser HMD 25 announce headsets
8 announce boxes with talkback
5 Sennheiser ME 66 short shotguns
3 Shure SM 89 long shotguns
3 Shure SM 89 Short shotguns
5 Shure Beta 58
4 Sennheiser MD 46
4 Sennheiser 416
4 Sony ECM 77
4 Sony ECM 66
10 Shure FP 23 line amps
2 VP 88

RECORDING

1 AJ- HD-1800 DVC Pro
2 Sony HDCAM
2 AJA Ki Pro Rack Record/Playback
3- 6 ch EVS XT-3 LSM
1- 6 ch EVS XT-3 RO
1- 4 ch EVS Spotbox
X-File3 and Sports Hub

2 DVD Recorders

ROUTING

N Vision 288 x 504

224 X 256 AES

192 X 192 Analog

COMMUNICATIONS

RTS ADAM 190 ports Tribus & Rvon

KP 32/ KP 12/ DKP 12/ KP 32 CLD Panels

12 PL channels

16 IFB channels

20 BP 325

2 Biscuit Boxes

8 Telephone interfaces

2 Radio base stations

12 Motorola GP 100

Partner 18-line key system

8 QKTs

4 Ringdowns

MVP MONITORING SYSTEM

Production

8 46" Panasonic LCD

8 10" Marshall

Tape/ Dual

12 32" Sony LCD

Video

2 32" Sony LCD

3 Sony BVM L230

Rear Bench

8 Marshall Dual V-R1042 10" HD each

Field

4 Sony 9" LCD

4 JVC 17" LCD

2 Sony 20" LCD

POWER

208 volt 3 phase 200 amps

150' Camlok cable

20 ton HVAC

DIMENSIONS / WEIGHT

55' trailer with AC

Deployed footprint

50'X5' curbside expando

25'X4' roadside expando

13'6" height clear

8'6" wide clear (transport)

80,000 pounds

Available upon request:

2 Sony HDLA 1500 HD Build Up

2 Canon 86x Semi Servo Lens

Wide Angle lenses

Additional microphones

Fiber Booth Kit

Sap 612

4 Model 47 PL's

4 Model 46 PL's

4 Model 42A IFB's

Adder 16 send 8 Receive

*53' support unit required for larger shows