

IMS PRODUCTIONS • 4555 W 16th ST • INDIANAPOLIS, IN 46222  
OFFICE 317.492.8770 • WEB IMSPRODUCTIONSTV.COM

# HD-3 DIMENSIONS & LAYOUT

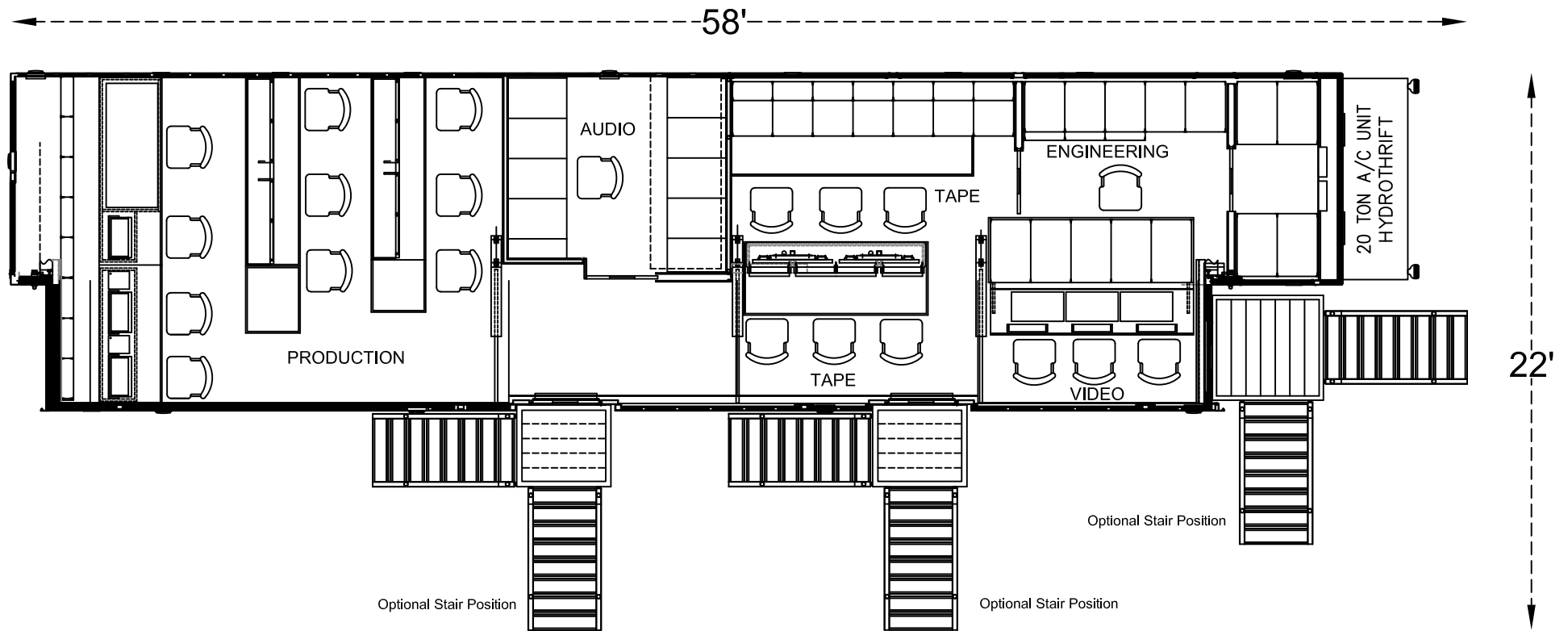

# HD-3 SPECIFICATIONS

## DIMENSIONS / WEIGHT

53' Trailer with AC  
80,000 lbs.  
Deployed footprint 58'x21'

## POWER

208V/240V 3 Phase 200 Amps  
200' Power Cable

## PRODUCTION

3 Bench Expando  
4 Position 1st Bench  
3 Position 2nd and 3rd Benches

## SWITCHING

GrassValley KAYENNE K-Frame HD Switcher:  
104 Inputs  
56 Dual Outputs  
5 MEs  
30 Keys  
30 2D DPMs  
8 3D IDPMs  
4 3D eDPMs  
32GB Image Store  
16 Chroma Keys  
Flexikey for Double Take  
Programmable Clean Feed  
Kurl, Defocus, Glow  
4 Match Def I/O Conversions  
4-Ch External Clip Store Package w/10+ hrs

## GRAPHICS

Chyron Mosaic eFX XL (Leitch)  
Lyric Pro 8.5, 8.6, 8.7, 8.8  
Photo Shop CS6  
Microsoft Office 2013  
Fingerworks Telestrator

## CAMERAS

12 Sony HDCU2500 CCUs with HDFX200 Adapters (Wired for 16)  
1 Sony BPU4000 with SSMO License  
9 Sony HDC2400L Cameras with dual filter wheel option  
2 Sony HDC2500L Cameras  
1 Sony HDC4300 Camera with SSMO License  
All cameras equipped with SMPTE Side Panels  
Digital TRIAX Side Panels available (except HDC4300)  
7 Sony HDLA-B Sleds with OLED Outdoor Viewfinders  
6 Sony 2" B/W HH Viewfinders  
6 Canon 22x HH Lenses  
4 Canon XJ95X8.6 Lenses with Image Stabilization  
3 Canon XJ80X8.8 Lenses with Image Stabilization  
7 Mathews MT-1 Sticks  
7 Vector 750 Panheads  
4 Vinten Vision 100 ENG Tripods  
2 Panasonic HD POVs with Magic Arms and Tripods  
12 Telecast SHEDs and HDX Box

## VIDEO PROCESSING

32 Frame Sync/Up-Down-Cross Converters  
48 Down Converting Monitoring DAs  
5 Color Correctors  
12 Analog to Digital Converters

## AUDIO

Calrec Artemis Beam with 96x96 Analog, 64x64 AES, and 12x12 MADI I/O  
Dual RTW Meters with Loudness Monitoring  
68 Motorized Faders  
64 Multitracks  
32 Aux Busses  
16 Groups  
8 Mains  
ENCO DAD  
CD Player  
2 DigiCarts - SD Card  
6 Dual Talkback Boxes with HMD-26 Headsets  
DaySequerra Package consisting of:  
2 Downmix Encoders  
2 Upmix Decoders  
1 4-Channel Mono-to-Stereo Synthesizer  
6 Sennheiser ME-66 Shotgun Microphones  
6 Sennheiser ME-67 Shotgun Microphones  
6 Sennheiser MKH-416 Shotgun Microphones  
4 Audio Technica AT-4029 Stereo Shotguns  
8 Sennheiser MD-46 Microphones  
4 Shure VP-88 Stereo Microphones  
6 Sony ECM-77 Lavalier Microphones  
2 Sony ECM-66 Lavalier Microphones

## RECORDING-REPLAY

Sony HDWD 1800 HDCAM, IMX, DIGIBETA, SX  
Sony HDW 1800 HDCAM  
2 Sony PDWHD 1500 XDCAM  
2 BlueRay/DVD Recorders  
4- 8 Channel XT-3 Channel MAX LSM (2 are licensed for SSMO)  
1- 12 Channel XT-3 Channel MAX w/SSMO License  
1- 6 Channel XS Spot Box  
X-File 3 with Transcoding  
**Available Codecs:** MJPEG; MPEG 2 INTRA; VC-3HD; Avid DNxHD; Apple ProRes 422 & ProRes LT; DVCPro HD; AVC-Intra 100

## ROUTING

Evertz EQX Video Router  
384x384 3G/HD/SD EQX Router of which 96x96 support audio embedding/de-embedding  
22 X-Link Outputs feeding 48 VIP 16x2 Multiviewer Cards  
Evertz EMR Audio Router  
96x96 Stereo Analog Audio  
96x96 AES Audio  
19x19 MADI

## COMMUNICATIONS

RTS Adam System  
128 Analog Ports  
64 MADI Ports  
32 RVON Ports  
16 OMNEO Ports  
LCP-102  
18 KP 32 Intercom Panels  
10 KP 12 Intercom Panels  
1 KP 32 RVON Intercom Panel  
12 Channels of Powered PL  
SAP 1626  
16 Channels of IFB  
20 BP 325 Beltpacks  
16 IFB 4030 Beltpacks  
6 TIFF 4000s  
8 QKTs  
16 CO Line Phone system  
2 Motorola UHF Base Stations Integrated with Intercom  
6 Hand Held Radios

## VIDEO MONITORING

Production – 15x 32" Samsung LCD Monitors  
Second Bench – 10x 9" Marshall LCD Monitors  
2x 17" HP and 1x 24" NEC LCD Monitors  
Third Bench - 10x 9" Marshall LCD monitors  
2x 17" HP and 1x 24" NEC LCD Monitors  
Recording/Replay – Front Bench 2x 40" NEC LCD Monitors, Back Bench - 10x 24" HP LCD Monitors  
4x 16" Marshall Monitors  
Video – 3x 17" Sony Trimeter EL Monitors  
6 Tektronix WFM7200s  
4x 24" HP LCD Monitors  
Audio – 2x 32" Samsung LCD Monitors  
Field – 9x 17" Viewsonic LCD Monitors  
4x Sony 9" LMD9050s

## Field Cable

2- 125' 5-Pair TRIAX Mults  
10 250' TRIAX  
4 500' TRIAX  
10 250' SMPTE  
4 500' SMPTE  
2 500' DT-12  
8 250' DT-12  
8 100' DT-12  
6 50' DT-12  
4 250' 4-Pair XLR  
4 250' TAC-12  
4 500' TAC-12  
4 1500' TAC-12  
5 125' 10-Pair Coax Mults

## Available upon request:

Additional microphones  
Additional Tactical Fiber  
Wide Angle lenes

## Fiber Booth Kit #1

8 IFBs  
6 PLs with SAP-612  
24 Mic/Line Inputs  
8 Line Outputs  
3 HD Video Inputs  
9 HD Video Outputs

Evertz CWDM transport  
RVON Intercom panels  
HMI Lighting  
Teleprompter  
Adobe Premiere System

IMS PRODUCTIONS • 4555 W 16th ST • INDIANAPOLIS, IN 46222  
OFFICE 317.492.8770 • WEB IMSPRODUCTIONSTV.COM

# HD-3 PRODUCTION MONITORS

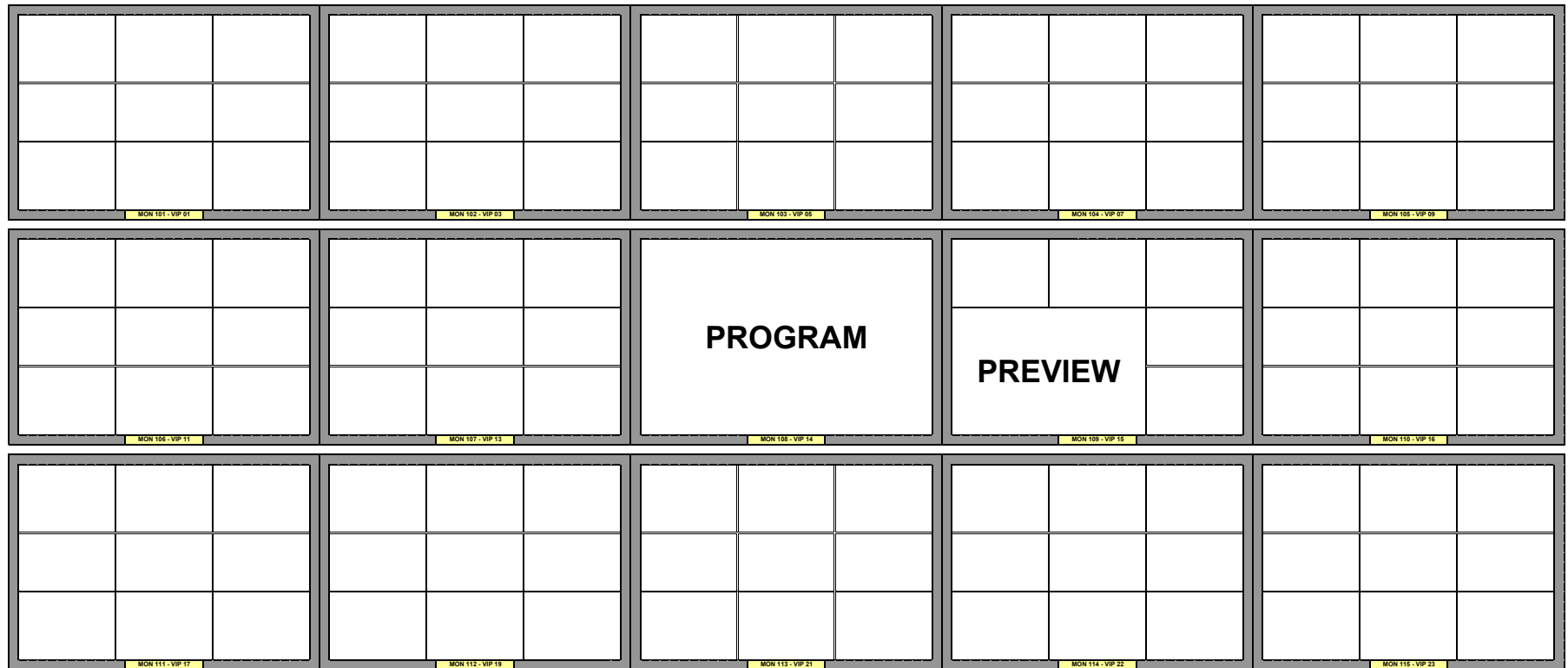

**IMS PRODUCTIONS • 4555 W 16th ST • INDIANAPOLIS, IN 46222**  
**OFFICE 317.492.8770 • WEB IMSPRODUCTIONSTV.COM**

# HD-3 P2 MONITOR

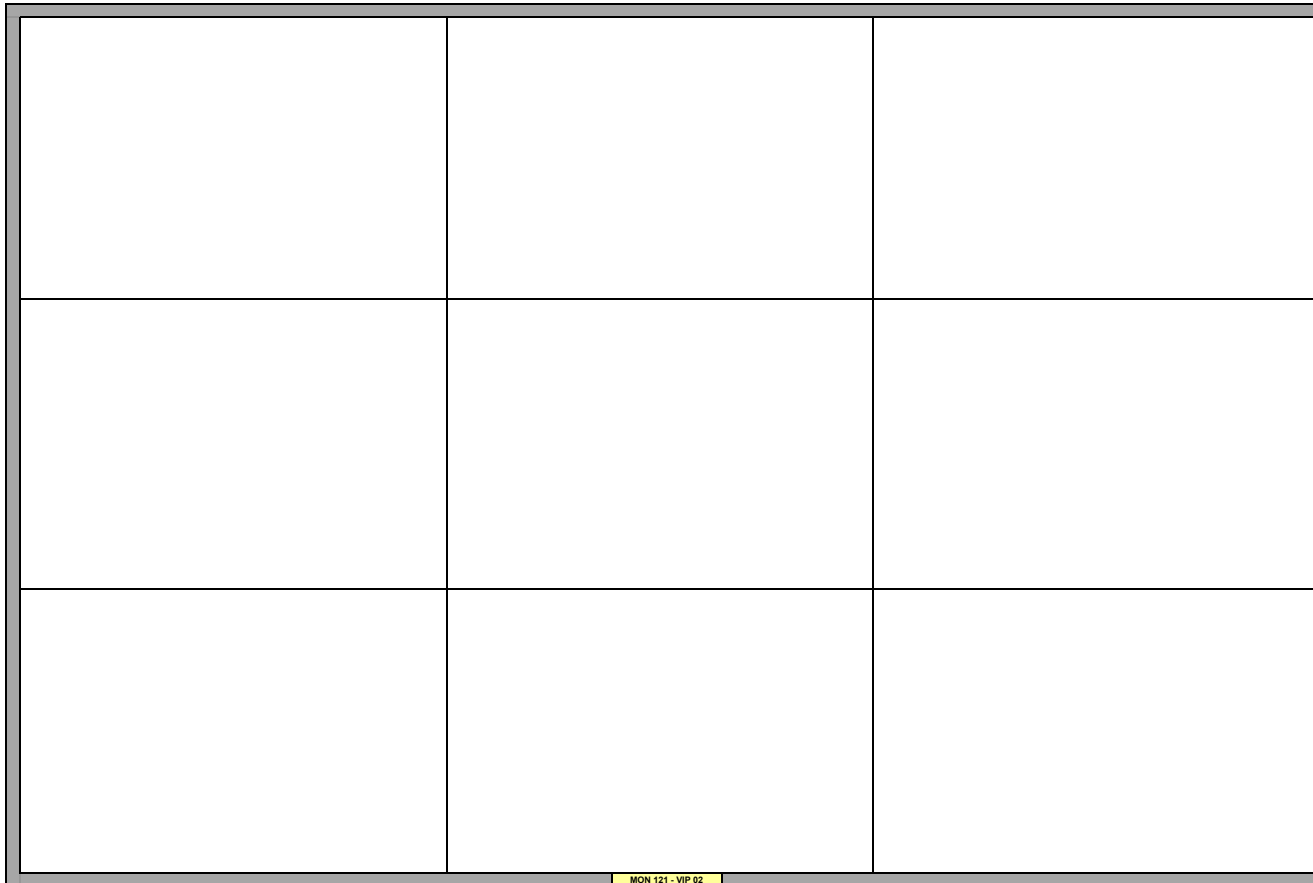

IMS PRODUCTIONS • 4555 W 16th ST • INDIANAPOLIS, IN 46222  
OFFICE 317.492.8770 • WEB IMSPRODUCTIONSTV.COM

# HD-3 P3 MONITOR

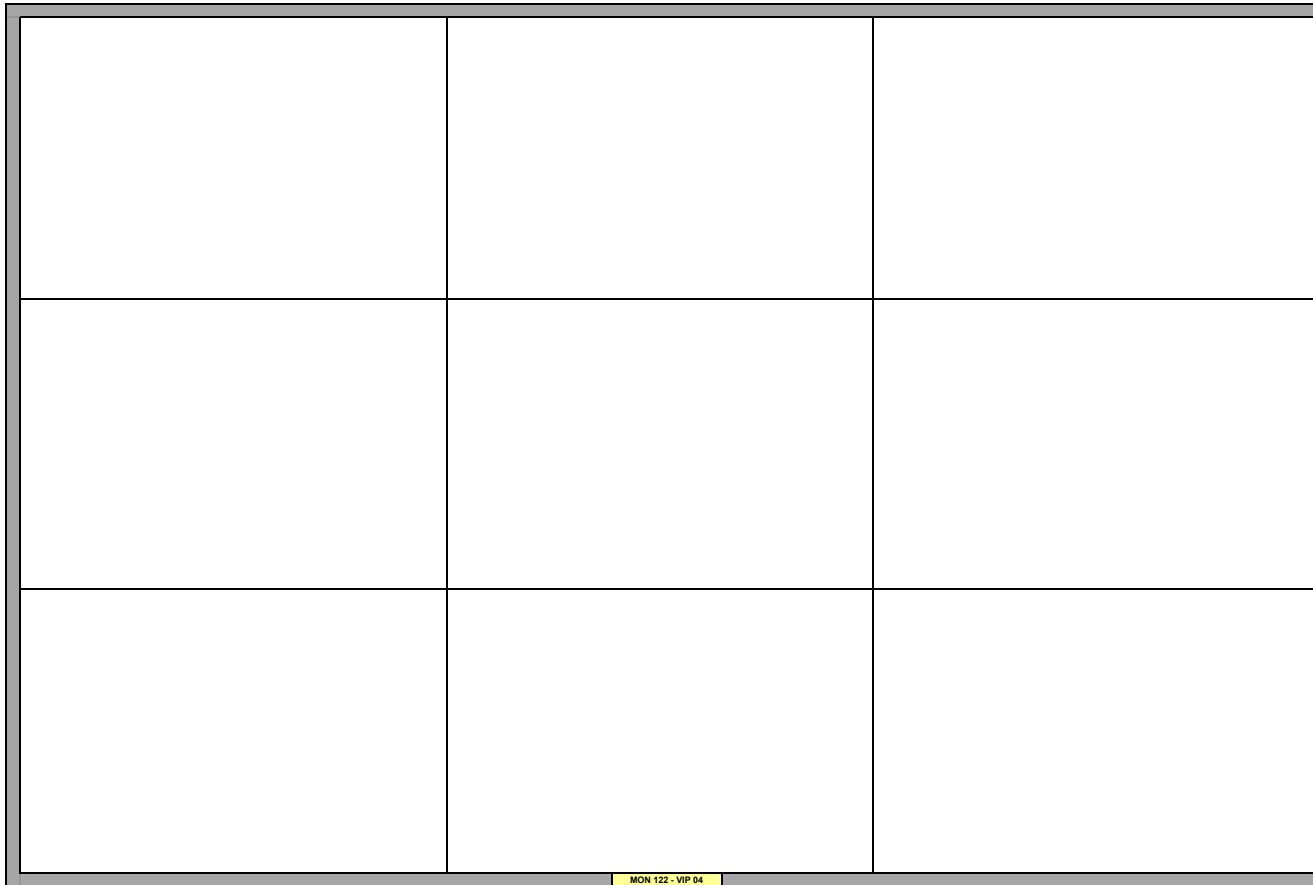

IMS PRODUCTIONS • 4555 W 16th ST • INDIANAPOLIS, IN 46222  
OFFICE 317.492.8770 • WEB IMSPRODUCTIONSTV.COM

# HD-3 RECORDING FRONT BENCH MONITORS

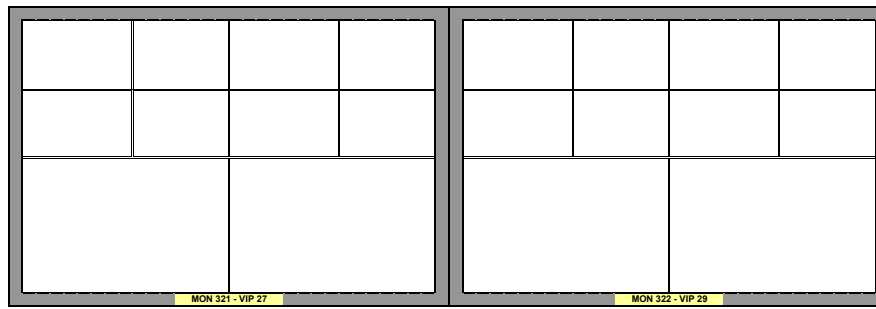

IMS PRODUCTIONS • 4555 W 16th ST • INDIANAPOLIS, IN 46222  
OFFICE 317.492.8770 • WEB IMSPRODUCTIONSTV.COM

# HD-3 RECORDING REAR BENCH

MON 301 - VIP 10			MON 302 - VIP 12			MON 303 - VIP 18			MON 304 - VIP 20			MON 305 - VIP 22		
MON 306 - VIP 24			MON 307 VIP 26			MON 308 - VIP 31			MON 309 - VIP 33			MON 310 - VIP 32		

IMS PRODUCTIONS • 4555 W 16th ST • INDIANAPOLIS, IN 46222  
OFFICE 317.492.8770 • WEB IMSPRODUCTIONSTV.COM

# HD-3 VIDEO MONITORS

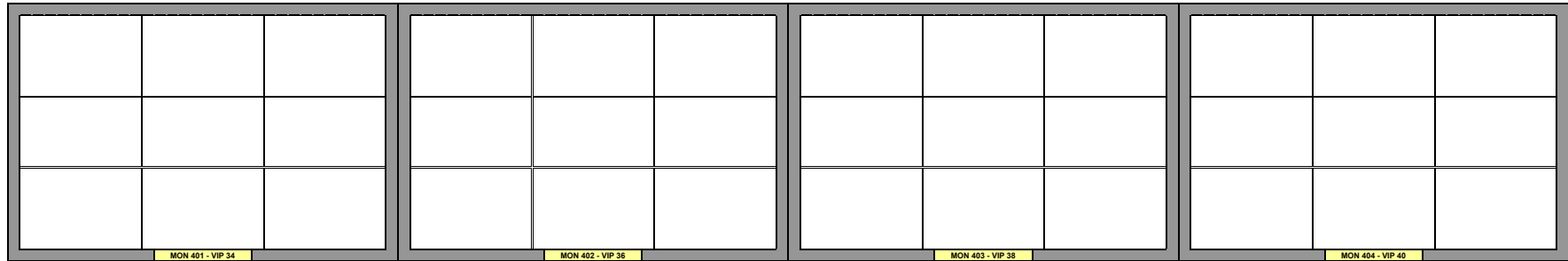



IMS PRODUCTIONS • 4555 W 16th ST • INDIANAPOLIS, IN 46222  
OFFICE 317.492.8770 • WEB IMSPRODUCTIONSTV.COM

## HD-3 AUDIO ROOM MONITORS

